



Why Local Developers and Investors Are Vital for CNY's Transformation

Guy Hart, Jr., Managing Partner

November 9, 2023



Do we have a local attitude
problem? Analytics over Bias
in Assessing Risk/Reward

Do we have a local attitude problem? Analytics over Bias in Assessing Risk/Reward

1

Is the Central New York history of relocations causing too much skepticism?

2

Why aren't more local investors and developers part of the coming expansion?

3

International, national and super-regional interests will benefit, and that's a good thing!

Do we have a local attitude problem? Analytics over Bias in Assessing Risk/Reward

4

Can local investors and others be part of the growth?

5

How can our projects help attract more quality employers, captivate talent and support continuous growth?

6

How can our region have projects that look like they do in other parts of the country?

Understanding the Capital Stack and How It Needs Balance to Drive Excellence

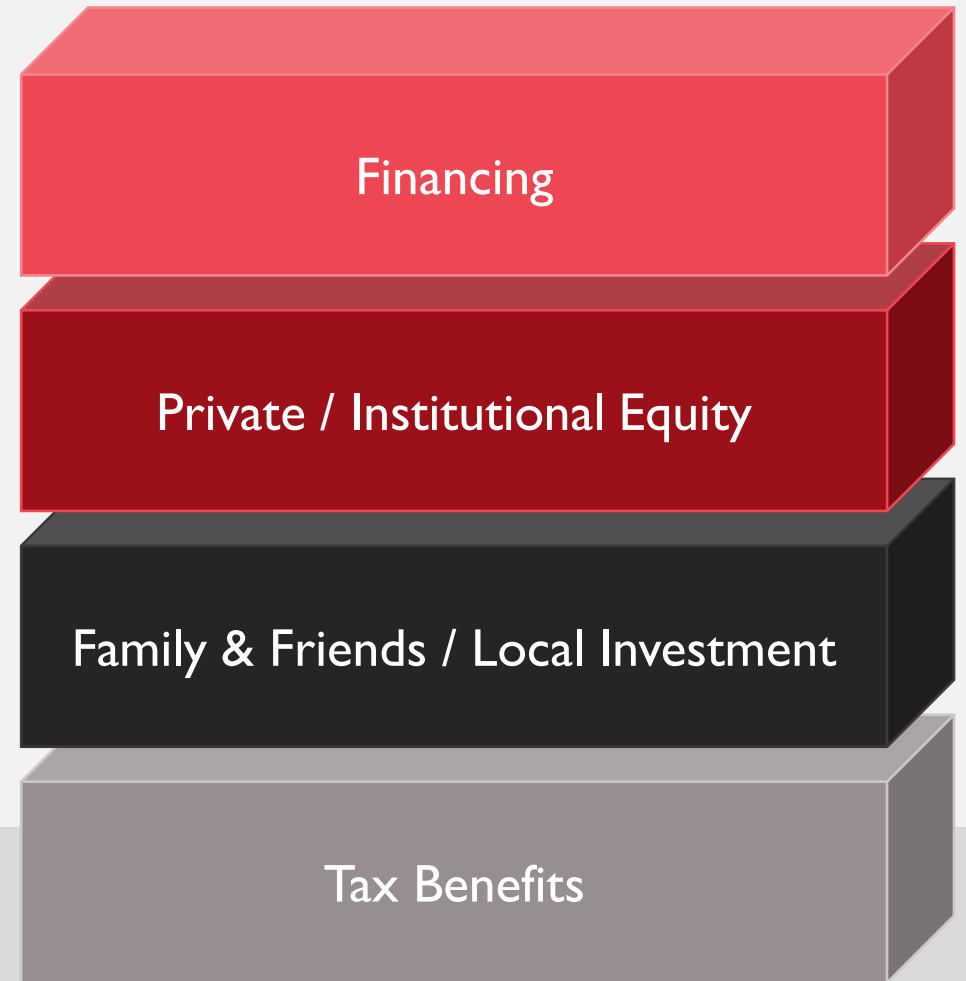

With a strong capital investment stack,
you get better development.

Who is Hart Lyman?

- Full-service, vertically integrated real estate development firm founded and headquartered in Syracuse, NY.
- Leader in building strong industry relationships enable the firm to develop high quality, contextual projects.
- Community focused real estate developer that builds a legacy of growth, innovation, and prosperity for the neighborhoods they serve.



Our History

- A second-generation 50+ year old firm deeply rooted in Central New York with experience across the U.S. and internationally
- Proudly developed over 3 million square feet of commercial property, totaling over \$1 billion through the eastern U.S.



Great Northern Mall

- The visionary project is the first of its kind in upstate NY, inspired by County Executive Ryan McMahon's comprehensive plan to create vibrant "town centers" throughout the county.
- The project reflects our local commitment to addressing the housing shortage and accommodating expected growth from Micron.
- The project will be a live work play community that will include health care, entertainment, grocery, retail and a range of community amenities.

Great Northern Mall Today



Conifer / Hart Lyman Partnership

New Partnership with Conifer Realty

- Over 200 apartment communities in New York, New Jersey, Pennsylvania and Maryland.
- Expanding into new markets across the East Coast to fulfill the dire need for high-quality, affordable housing.



Conifer / Hart Lyman Partnership

New Partnership with Conifer Realty

- Leading Rochester-based real estate development, construction and management and ownership of high-quality, affordable housing communities.
- Since inception in 1975, Conifer has grown considerably, owning and managing nearly 15,000 multifamily apartments.

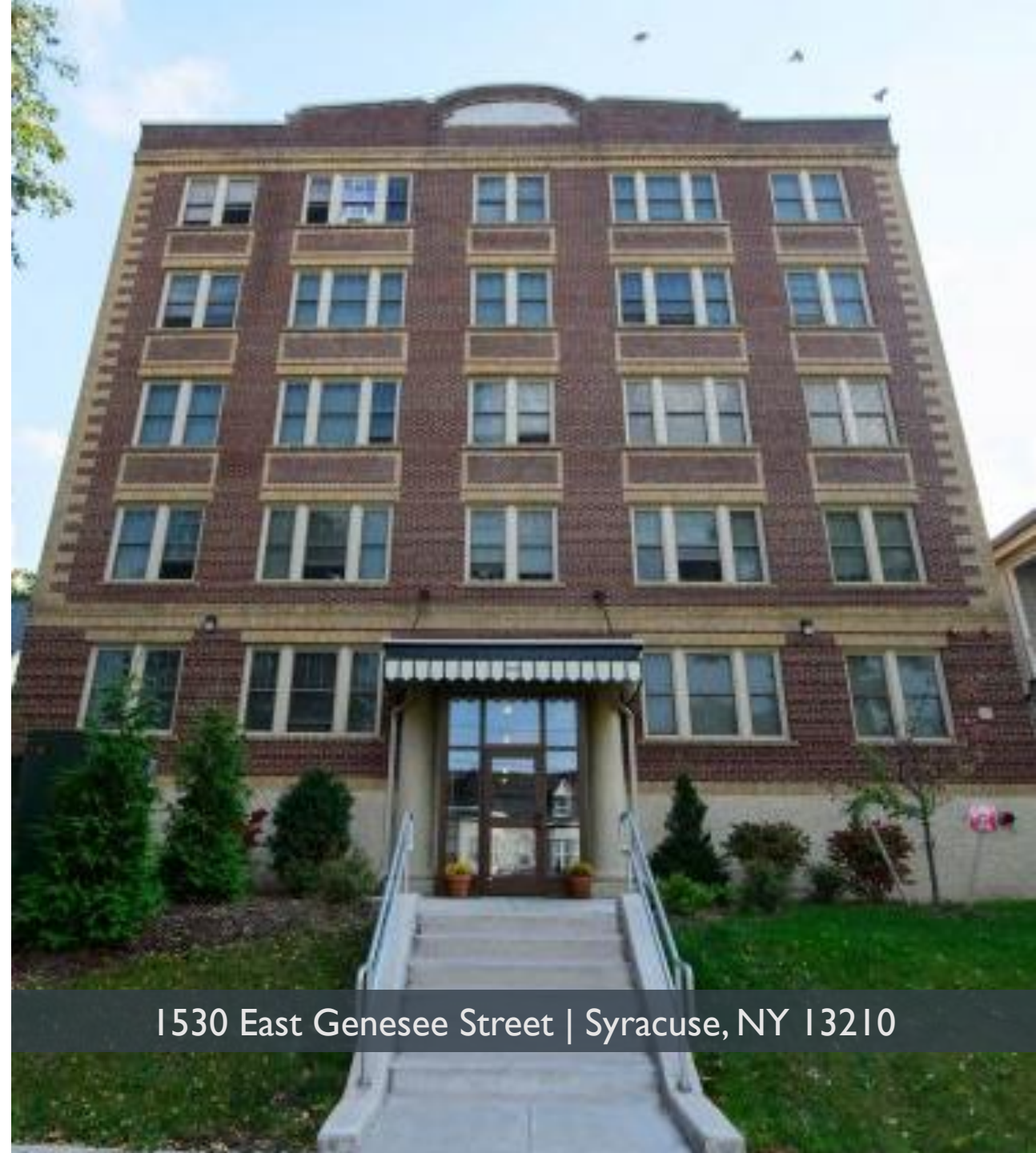

1530 East Genesee Street | Syracuse, NY 13210



QPK Design Recent Successes

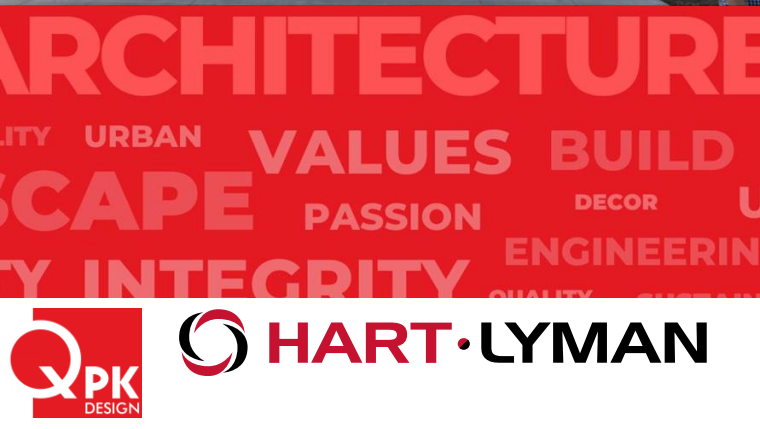
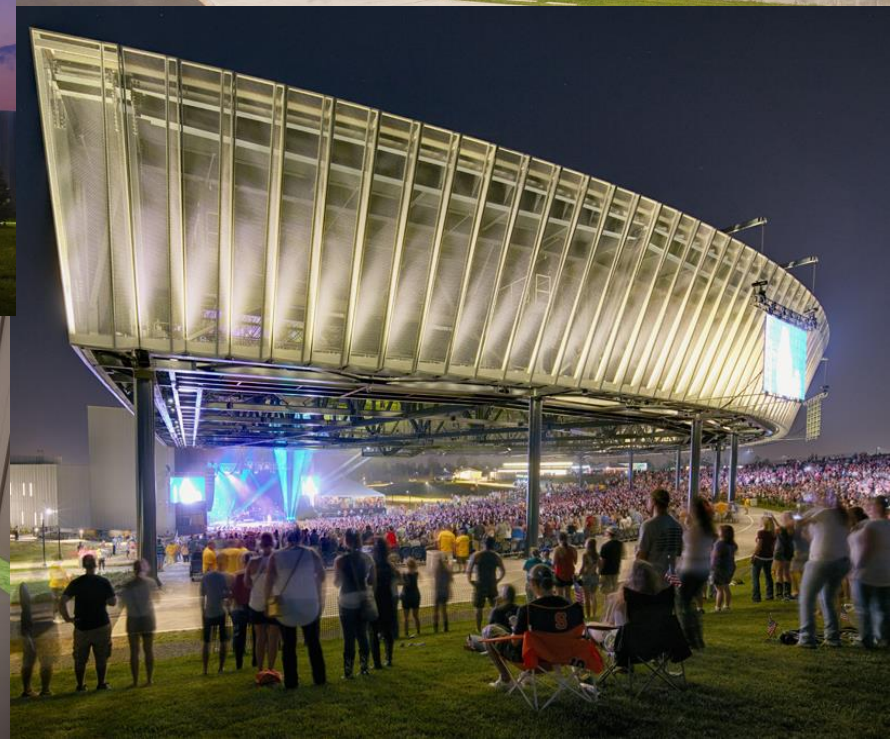

Great Northern Mall

- Construction is anticipated to commence next year after further refinement of the project's concept and site planning.
- Teams at Conifer and Hart Lyman, comprising myriad multidisciplinary dedicated professionals and best-in-class third parties, are prepared to drive the project forward with measured determination.

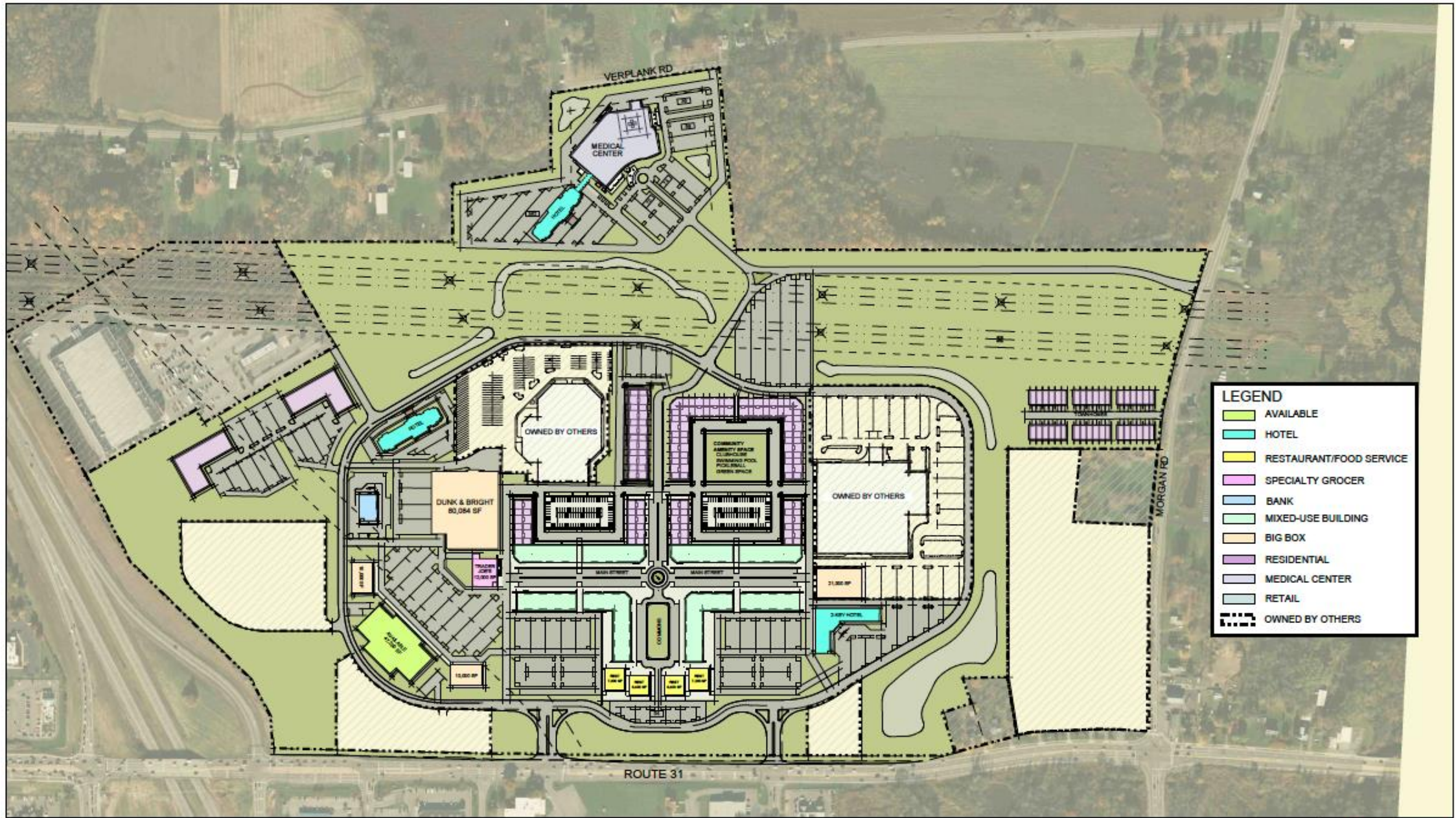



Lakeshore Village

- Consistent with Onondaga County's comprehensive plan to create vibrant "town centers."
- Reimagining a country club into a flourishing lakefront resort village.
- Upscale community with restaurants, entertainment, retail shops and residential housing.
- Essential for attracting and recruiting employees to Central New York; just a short drive from the growing White Pine site.
- When complete, this \$500 million+ investment will create a first-of-its-kind lakefront community on the shores of Oneida Lake.

Lakeshore Village



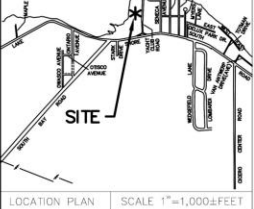

Site Plan

FUTURE
GOLF AREA



IT IS A VIOLATION OF LAW FOR ANY PERSON, UNLESS THEY ARE ACTING UNDER THE DIRECTION OF A LICENSED PROFESSIONAL, TO REPRODUCE, ADAPT, OR OTHERWISE REPRESENT OR IMITATE THE DESIGN OR LAYOUT OF A LICENSED PROFESSIONAL'S DESIGN OR LAYOUT WITHOUT THE WRITTEN PERMISSION OF THE LICENSED PROFESSIONAL. THE DESIGN OR LAYOUT IS THE PROPERTY OF THE LICENSED PROFESSIONAL AND IS NOT TO BE REPRODUCED, ADAPTED, OR OTHERWISE REPRESENTED OR IMITATED WITHOUT THE WRITTEN PERMISSION OF THE LICENSED PROFESSIONAL. THE DESIGN OR LAYOUT IS THE PROPERTY OF THE LICENSED PROFESSIONAL AND IS NOT TO BE REPRODUCED, ADAPTED, OR OTHERWISE REPRESENTED OR IMITATED WITHOUT THE WRITTEN PERMISSION OF THE LICENSED PROFESSIONAL.

PROPOSED LAKESHORE VILLAGE
LAKESHORE ROAD
CICERO, NY 13039

| No. | Submitted / Revision | App'd. | By | Date |
|-----|----------------------|--------|----|------|
| | | | | |
| | | | | |
| | | | | |
| | | | | |
| | | | | |
| | | | | |
| | | | | |
| | | | | |
| | | | | |

Designed By: BB/AMV
Issue Date:

Drawn By: AMV
Project No:

Checked By: JFT
Scale:

With collective efforts,
Central New York can become
a shining city on the hill.
Are you ready?

Thank you!

Guy Hart, Jr.

Managing Partner

guy.hartjr@hlcoss.com | 315-671-1500 | hlcoss.com